



3 LAYERS

LIGHT GROOVES

STEEL

POLYSTYRENE SANDWICH DOOR

THICKNESS 2"

R-9.4 INSULATION



Mid-America Series



12' x 14', White doors

FEATURES AND BENEFITS

A POLYSTYRENE INSULATION

- CFC-free contoured polystyrene core of our sections is bonded with polyurethane reactive hot melt glue to obtain **energy efficiency**.



B FULL-LENGTH REINFORCING PLATES

- 20-gauge hot dipped galvanized steel stiles running the full height of the section are attached to the interior face to ensure **a more rigid section** and also pre-punched with extruded holes for hinge attachment.

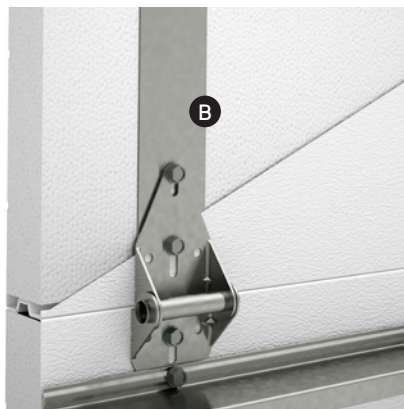

C CHOICE OF COLORS

- Beautiful light groove design is available in a choice of 3 classic colors that fit well with many building exteriors.



PANEL CONSTRUCTION

- 1 **Hot-dipped galvanized steel walls**
 - 25-gauge exterior and 26-gauge interior steel skin
 - Baked-on polyester paint. Can be repainted
 - Woodgrain finish on exterior side and stucco finish on interior side of the door
 - Same quality of corrosion-resistant steel for interior and exterior faces
 - Regardless of the color chosen, the inside is always White (door and window frames)
- 2 2" (50 mm) CFC-free **continuous sculpted polystyrene board bonded between steel faces** ensures a thermal-resistance rating of **R-9.4** (RSI 1.7 or $k=0.588 \text{ W/m}^2\text{K}$).
- 3 Sections are made with **1/4" (6 mm) wide grooves** for a subtle finish.
- 4 **Tongue & groove joints** between sections that fit seamlessly.
- 5 Continuous astragal **bottom weatherstripping** made of U-shaped flexible vinyl and held in place by an aluminum retainer provides additional reinforcement.
- 6 20-gauge **full-length** galvanized steel reinforcing plates placed inside the door provide a rock solid base for attaching hinges and struts.

Door weight: 1.98 lb/ft² (9.7 kg/m²)

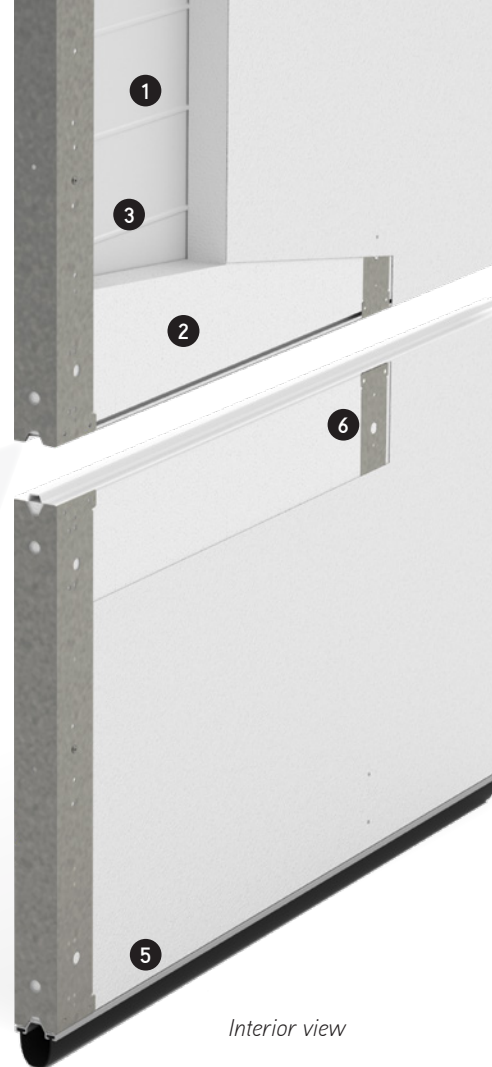

Interior view

SIZES

Widths In 1" (25 mm) increments	From 5' to 20'2" (1.5 m to 6.1 m)
Heights In 3" (76 mm) increments	From 6' to 18' (1.8 m to 5.5 m)

COLORS



White

Brown

Black Ice

Colors may slightly vary from images.

WINDOWS



Standard Windows
24" x 6" (610 mm x 152 mm) or
25" x 13" (635 mm x 330 mm)
Thermopane 1/2": Clear
Single glass 1/8": Clear
Colors: White and Black



Optional
20" x 13" (508 mm x 330 mm) or
41" x 16" (1041 mm x 406 mm)
Residential windows,
offered in 3 colors.

PANEL DESIGN



Light Grooves
1/8" deep, 1/4" wide

HARDWARE

See details with your Garaga dealer.

WARRANTY (LIMITED)

10 years against any perforation of steel due to rust
1 year on other door components



midamericadoor.com
garaga.com
info@garaga.com

US Head Office
1 800 364-3667
Ponca City, OK

Canadian Head Office
1 800 464-2724
St-Georges, QC



YOUR
DISTRIBUTOR