

SSI-24 | SSI-25



3 LAYERS DEEP GROOVES
STEEL POLYSTYRENE SANDWICH DOOR THICKNESS 2" R-9.4 INSULATION



8'6" x 9', White doors

FEATURES AND BENEFITS

A DEEP-GROOVED STEEL WALL

- Providing more **strength** and **additional bending resistance**, our sections are made with 1/2" deep and 2" wide horizontal grooves with alternating smaller grooves.
- SSI-24 **Heavy Duty** construction model and SSI-25 **Medium Duty** construction model are built with galvanized steel and factory applied white baked-on finish.



B POLYSTYRENE INSULATION

- CFC-free contoured polystyrene core of our sections is bonded with polyurethane reactive hot melt glue to obtain **energy efficiency**.

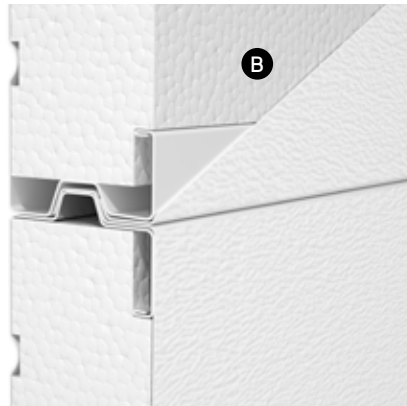

C VERTICAL INTERMEDIATE STILES

- 20-gauge hot dipped galvanized steel stiles running the full height of the section are attached to the interior face to ensure **a more rigid section** and also pre-punched with extruded holes for hinge attachment.

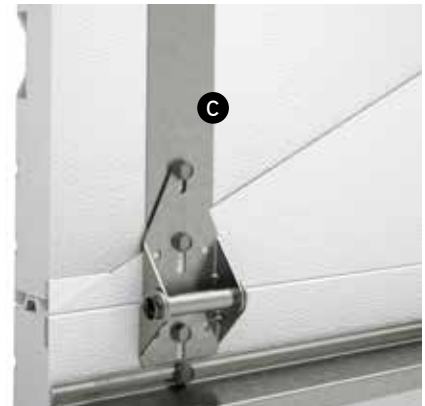

PANEL CONSTRUCTION

- 1 **Hot-dipped galvanized steel walls**
 - **Heavy Duty Model SSI-24:** 24-gauge exterior and 26-gauge interior steel skin
 - **Medium Duty Model SSI-25:** 25-gauge exterior and 26-gauge interior steel skin
 - Baked-on polyester paint. Can be repainted
 - Smooth finish on exterior side and stucco finish on interior side of the door
 - Same quality of corrosion-resistant steel for interior and exterior faces
- 2 2" (50 mm) CFC-free **continuous sculpted polystyrene board bonded between steel faces** ensures a thermal-resistance rating of **R-9.4** (RSI 1.7 or k=0.558 W/m²K).
- 3 Sections are made with **½" (13 mm) deep and 2" (50 mm) wide grooves** providing more strength to the door.
- 4 **Tongue & groove joints** between sections that fit seamlessly.
- 5 Continuous astragal **bottom weatherstripping** made of U-shaped flexible vinyl and held in place by an aluminum retainer provides additional reinforcement.
- 6 20-gauge galvanized steel vertical **center stiles** placed inside the door provide a rock solid base for attaching hinges and struts.

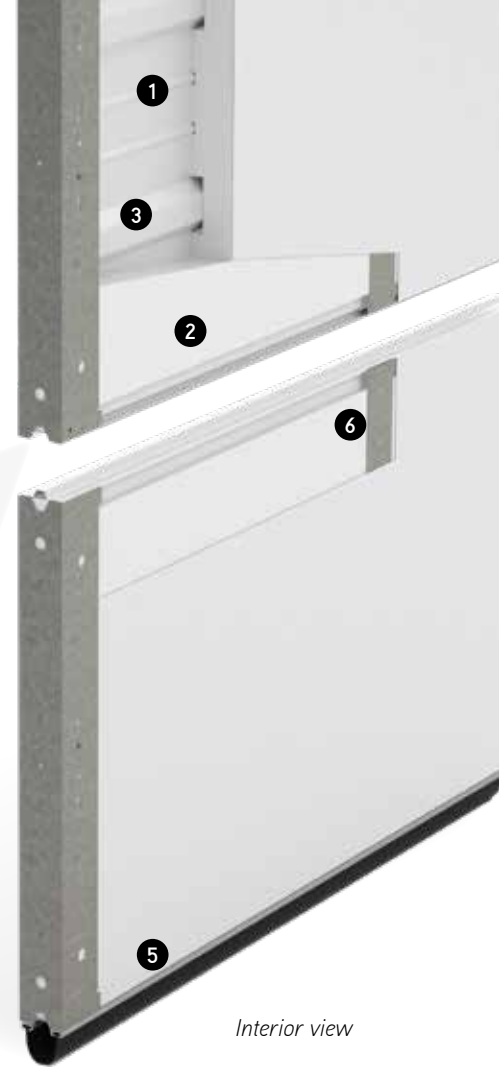

Interior view

Door weight: SSI-24: 2.10 lb/ft² (10.3 kg/m²)
SSI-25: 1.90 lb/ft² (9.3 kg/m²)

COLOR



White

Color may slightly varies from image.

MODEL



Deep Grooves
½" deep, 2" wide

SIZES

Widths In 1" (25 mm) increments	From 5' to 24'2" (1.5 m to 7.4 m)
Heights In 3" (76 mm) increments	From 6' to 18' (1.8 m to 5.5 m)

HARDWARE

See details with your garage door dealer or in the Garaga Industrial product brochure.

WINDOWS



Standard Windows
24" x 6" (610 mm x 152 mm) or
25" x 13" (635 mm x 330 mm)
Thermopane ½": Clear
Single glass ⅜": Clear
Color: Black

WARRANTY

Limited lifetime against cracks, splits or rusting through.
See warranty document for complete details.



midamericadoor.com
garaga.com
info@garaga.com

US Head Office
1 800 364-3667
Ponca City, OK



Canadian Head Office
1 866 960-2828
St-Georges, QC

YOUR
DISTRIBUTOR